

Pipe fittings and tubing T, MPL, PNZ

Connections M5, G1/8, G1/4, G3/8, G1/2
R1/8, R1/4, R3/8, R1/2, R3/4

When involved in factory maintenance or plant installation it is often difficult to be certain which size of fitting will be required. The camozzi pipe fitting range provides a cost effective solution to this problem. The full range includes straight, L-shaped, T-shaped and cross piece male or female couplings, all of which are available in a variety of thread sizes up to G1/2.

Material: brass OT58 (nickel-plated).

Treaded: GAS conical ISO 7 (BSPT)
GAS cylindrical ISO 228 (BSP).



FITTINGS

Fittings Mod. 2500...

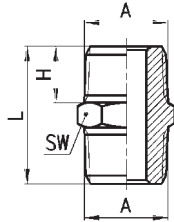

DIMENSIONS

Mod.	A	H	L	SW
2500 1/8	R1/8	7,5	19,5	12
2500 1/4	R1/4	11	27	14
2500 3/8	R3/8	11,5	28	17
2500 1/2	R1/2	14	33,5	22
2500 3/4	R3/4	16,5	40	27

Fittings Mod. 2501...

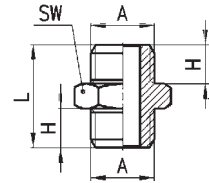

DIMENSIONS

Mod.	A	H	L	SW
2501 M5	M5	4	11,5	8
2501 1/8	G1/8	6	16,5	14
2501 1/4	G1/4	8	21	17
2501 3/8	G3/8	9	23	19
2501 1/2	G1/2	10	25,5	24

Fittings Mod. 2510...

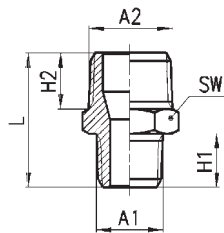

DIMENSIONS

Mod.	A1	A2	H1	H2	L	SW
2510 1/8 - 1/4	R1/8	R1/4	7,5	11	23,5	14
2510 1/8 - 3/8	R1/8	R3/8	7,5	11,5	24	17
2510 1/4 - 3/8	R1/4	R3/8	11	11,5	27,5	17
2510 1/4 - 1/2	R1/4	R1/2	11	14	30,5	22
2510 3/8 - 1/2	R3/8	R1/2	11,5	14	31	22
2510 1/2 - 3/4	R1/2	R3/4	14	16,5	37,5	27

Fittings Mod. 2511...

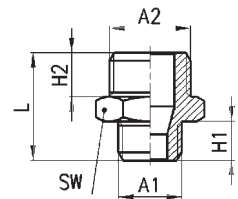

DIMENSIONS

Mod.	A1	A2	H1	H2	L	SW
2511 M5 - 1/8	M5	G1/8	4	6	14,5	14
2511 1/8 - 1/4	G1/8	G1/4	6	8	19	17
2511 1/8 - 3/8	G1/8	G3/8	6	9	20	19
2511 1/4 - 3/8	G1/4	G3/8	8	9	22	19
2511 1/4 - 1/2	G1/4	G1/2	8	10	23,5	24
2511 3/8 - 1/2	G3/8	G1/2	9	10	24,5	24

Fittings Mod. 2520...

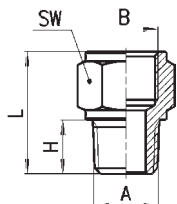

DIMENSIONS

Mod.	A	B	H	L	SW
2520 1/8 - 1/8	R1/8	G1/8	7,5	17,5	14
2520 1/8 - 1/4	R1/8	G1/4	7,5	21,5	17
2520 1/8 - 3/8	R1/8	G3/8	7,5	22	22
2520 1/4 - 1/4	R1/4	G1/4	11	25	17
2520 1/4 - 3/8	R1/4	G3/8	11	25,5	22
2520 1/4 - 1/2	R1/4	G1/2	11	29	27
2520 3/8 - 3/8	R3/8	G3/8	11,5	26	22
2520 3/8 - 1/2	R3/8	G1/2	11,5	29,5	27
2520 1/2 - 1/2	R1/2	G1/2	14	32	27

Fittings Mod. 2521...

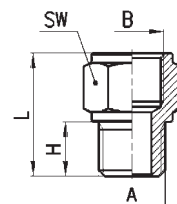

DIMENSIONS

Mod.	A	B	H	L	SW
2521 M5 - 1/8	M5	G1/8	4	14	14
2521 1/8 - 1/8	G1/8	G1/8	6	16	14
2521 1/8 - 1/4	G1/8	G1/4	6	20	17
2521 1/8 - 3/8	G1/8	G3/8	6	20,5	22
2521 1/4 - 1/4	G1/4	G1/4	8	22	17
2521 1/4 - 3/8	G1/4	G3/8	8	22,5	22
2521 1/4 - 1/2	G1/4	G1/2	8	26	27
2521 3/8 - 3/8	G3/8	G3/8	9	23,5	22
2521 3/8 - 1/2	G3/8	G1/2	9	27	27
2521 1/2 - 1/2	G1/2	G1/2	10	28	27

Fittings Mod. 2525...

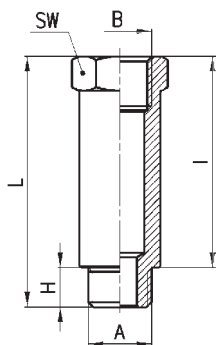

DIMENSIONS

Mod.	A	B	H	I	L	SW
2525 1/8 - 16	G1/8	G1/8	6	16	22	14
2525 1/8 - 36	G1/8	G1/8	6	36	42	14
2525 1/4 - 27	G1/4	G1/4	8	27	35	17
2525 1/4 - 43	G1/4	G1/4	8	43	51	17

Fittings Mod. 2530...

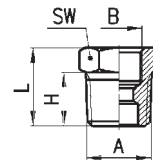

DIMENSIONS

Mod.	A	B	H	L	SW
2530 1/4 - 1/8	R1/4	G1/8	11	16	14
2530 3/8 - 1/8	R3/8	G1/8	11,5	16,5	17
2530 1/2 - 1/8	R1/2	G1/8	14	19,5	22
2530 3/8 - 1/4	R3/8	G1/4	11,5	16,5	17
2530 1/2 - 1/4	R1/2	G1/4	14	19,5	22
2530 1/2 - 3/8	R1/2	G3/8	14	19,5	22
2530 3/4 - 1/2	R3/4	G1/2	16,5	23,5	27

Fittings Mod. 2531...

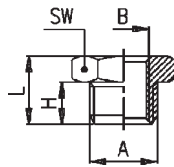

DIMENSIONS

Mod.	A	B	H	L	SW
2531 1/8 - M5	G1/8	M5	6	10,5	14
2531 1/4 - 1/8	G1/4	G1/8	8	13	17
2531 3/8 - 1/8	G3/8	G1/8	9	14	19
2531 1/2 - 1/8	G1/2	G1/8	10	15,5	24
2531 3/8 - 1/4	G3/8	G1/4	9	14	19
2531 1/2 - 1/4	G1/2	G1/4	10	15,5	24
2531 1/2 - 3/8	G1/2	G3/8	10	15,5	24

Fittings Mod. 2543...

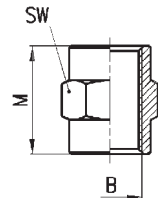

DIMENSIONS

Mod.	B	L	SW
2543 M5	M5	11	8
2543 1/8	G1/8	15	14
2543 1/4	G1/4	22	17
2543 3/8	G3/8	24	22
2543 1/2	G1/2	30	27

Fittings Mod. 2553...

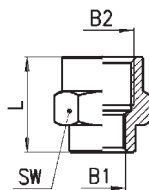

DIMENSIONS

Mod.	B1	B2	L	SW
2553 M5 - 1/8	M5	G1/8	13	14
2553 1/8 - 1/4	G1/8	G1/4	19,5	17
2553 1/8 - 3/8	G1/8	G3/8	20	22
2553 1/8 - 1/2	G1/8	G1/2	23,5	27
2553 1/4 - 3/8	G1/4	G3/8	23	22
2553 1/4 - 1/2	G1/4	G3/8	27	27
2553 3/8 - 1/2	G3/8	G1/2	27,5	27

Fittings Mod. 2611...

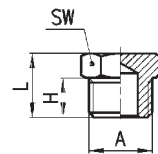

DIMENSIONS

Mod.	A	H	L	SW
2611 M5	M5	4	7,5	8
2611 1/8	G1/8	6	10,5	14
2611 1/4	G1/4	8	13	17
2611 3/8	G3/8	9	14	19
2611 1/2	G1/2	10	15,5	24

Fittings Mod. 2610 3/4

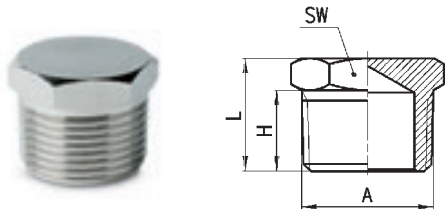

DIMENSIONS

Mod.	A	H	L	SW
2610 3/4	R3/4	16,5	23	27

Fittings Mod. 2613...



DIMENSIONS

Mod.	B	L	SW
2613 1/8	G1/8	11	12
2613 1/4	G1/4	19	14
2613 3/8	G3/8	20	17
2613 1/2	G1/2	24	19

Fittings Mod. 2601...

DIMENSIONS

Mod.	N	A	C	H	I	L	SW
2601 2 - M5	2	M5	1,2	4	8	16	8
2601 4,5 - M5	4	M5	2,5	4	15	23	8
2601 7 - 1/8	7	G1/8	4	6	20	30	12
2601 7 - 1/4	7	G1/4	4	8	20	33	17
2601 8 - 1/8	8	G1/8	5	6	20	30	12
2601 9 - 1/8	9	G1/8	5	6	20	30	12
2601 9 - 1/4	9	G1/4	6	8	20	33	17
2601 9 - 3/8	9	G3/8	6	9	20	34	19
2601 12 - 1/4	12	G1/4	9	8	20	33	17
2601 12 - 3/8	12	G3/8	9	9	20	34	19
2601 12 - 1/2	12	G1/2	9	10	20	35,5	24
2601 17 - 3/8	17	G3/8	13	9	24	38	19
2601 17 - 1/2	17	G1/2	13	10	24	39,5	24

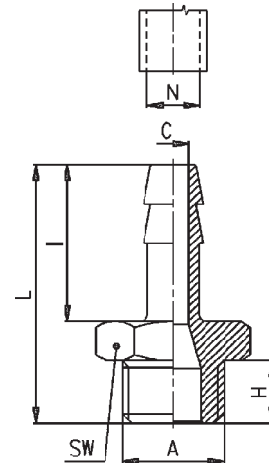

Fittings Mod. 2010...

DIMENSIONS

Mod.	A	E	H	SW
2010 1/8	R1/8	14	7,5	9
2010 1/4	R1/4	15,5	11	12
2010 3/8	R3/8	19,5	11,5	14
2010 1/2	R1/2	21,5	14	16

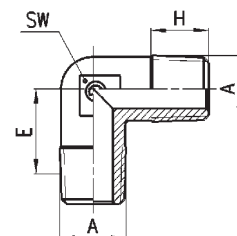

Fittings Mod. 2013...

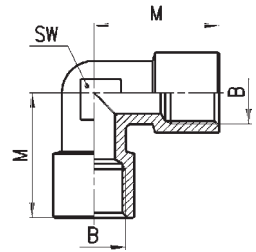

DIMENSIONS

Mod.	B	M	SW
2013 1/8	G1/8	21	12
2013 1/4	G1/4	25,5	14
2013 3/8	G3/8	28	16
2013 1/2	G1/2	33	21

Fittings Mod. 2021 and Mod. 2020...

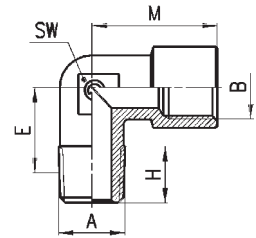

DIMENSIONS

Mod.	A	B	E	H	M	SW
2021 M5 - M5	M5	M5	9	4	10,5	9
2020 1/8 - 1/8	R1/8	G1/8	15	7,5	21	12
2020 1/4 - 1/4	R1/4	G1/4	19	11	25,5	14
2020 3/8 - 3/8	R3/8	G3/8	19,5	11,5	28	16
2020 1/2 - 1/2	R1/2	G1/2	23	14	33	21

Fittings Mod. 2050..

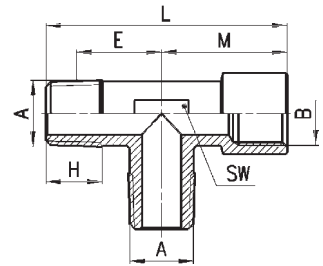

DIMENSIONS

Mod.	A	B	E	H	L	M	SW
2050 1/8 - 1/8	R1/8	G1/8	15	8,5	39	21	12
2050 1/4 - 1/4	R1/4	G1/4	19	11	49	25,5	14
2050 3/8 - 3/8	R3/8	G3/8	19,5	11,5	52,5	28	16
2050 1/2 - 1/2	R1/2	G1/2	23	14	63	33	21

Fittings Mod. 2060....

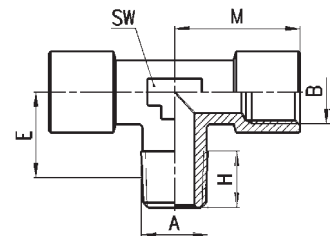

DIMENSIONS

Mod.	A	B	E	H	M	SW
2060 1/8 - 1/8	R1/8	G1/8	15	8,5	21	12
2060 1/4 - 1/4	R1/4	G1/4	19	11	25,5	14
2060 3/8 - 3/8	R3/8	G3/8	19,5	11,5	28	16
2060 1/2 - 1/2	R1/2	G1/2	23	14	33	21

Fittings Mod. 2080...

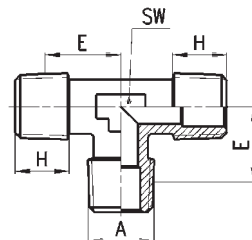

DIMENSIONS

Mod.	A	E	H	SW
2080 1/8	R1/8	14	7,5	9
2080 1/4	R1/4	15,5	11	12
2080 3/8	R3/8	19,5	11,5	14
2080 1/2	R1/2	21,5	14	16

Fittings Mod. 2070...

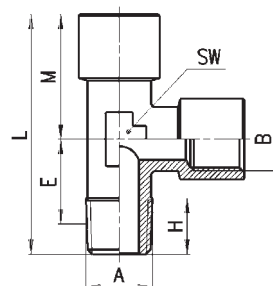

DIMENSIONS

Mod.	A	B	E	H	L	M	SW
2070 1/8 - 1/8	R1/8	G1/8	15	8,5	39	21	12
2070 1/4 - 1/4	R1/4	G1/4	19	11	49	25,5	14
2070 3/8 - 3/8	R3/8	G3/8	19,5	11,5	52,5	28	16
2070 1/2 - 1/2	R1/2	G1/2	23	14	63	33	21

Fittings Mod. 2090...

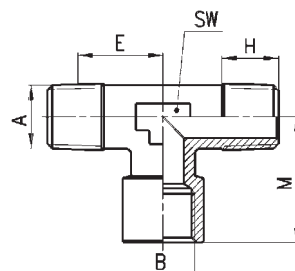

DIMENSIONS

Mod.	A	B	E	H	M	SW
2090 1/8 - 1/8	R1/8	G1/8	14	8,5	21	12
2090 1/4 - 1/4	R1/4	G1/4	15,5	11	25,5	14
2090 3/8 - 3/8	R3/8	G3/8	19,5	11,5	28	16
2090 1/2 - 1/2	R1/2	G1/2	21,5	14	33	21

Fittings Mod. 2003...

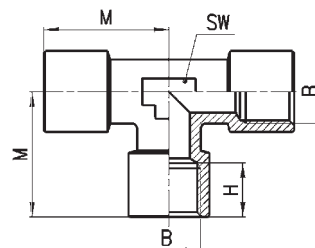

DIMENSIONS

Mod.	B	H	M	SW
2003 1/8	G1/8	7,5	21	12
2003 1/4	G1/4	11	25,5	14
2003 3/8	G3/8	11,5	28	16
2003 1/2	G1/2	15	33	21

Fittings Mod. 2040...

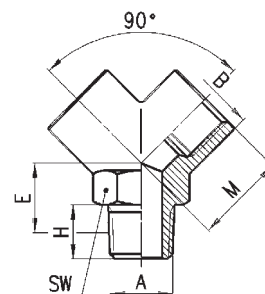

DIMENSIONS

Mod.	A	B	E	H	M	SW
2040 1/8 - 1/8	R1/8	G1/8	13	8,9	17,5	14
2040 1/4 - 1/4	R1/4	G1/4	13	11	18,5	17
2040 3/8 - 3/8	R3/8	G3/8	18	13	23	22
2040 1/2 - 1/2	R1/2	G1/2	22,5	15,3	27,5	26

Fittings Mod. 2043...

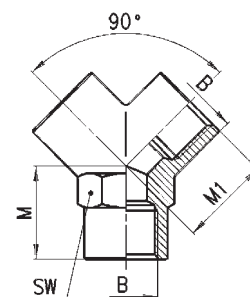

DIMENSIONS

Mod.	B	M	M1	SW
2043 1/8	G1/8	17,5	17,5	14
2043 1/4	G1/4	19	18,5	17
2043 3/8	G3/8	23,5	22,5	22
2043 1/2	G1/2	28	28	26

Fittings Mod. 2033...

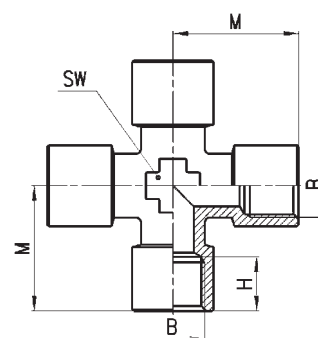

DIMENSIONS

Mod.	B	H	M	SW
2033 1/8	G1/8	7,5	19,5	12
2033 1/4	G1/4	11	25,5	14
2033 3/8	G3/8	11,5	26,5	16

Fittings Mod. 2023...

- Assembly possible only with Mod. SCU, SCO, SVU...M5
- * assembly required with Mod. 1635.

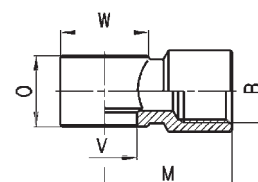

DIMENSIONS

Mod.	B	M	O	V	W
2023 M5 - M5	M5	10,5	9	5,1	□9
2023 M5 - M6	M5	10,5	9	6,1	□9 •
2023 1/8 - 1/8	G1/8	21	14,5	9,8	Ø14
2023 1/4 - 1/4	G1/4	26	14,5	13,2	Ø18 *
2023 3/8 - 3/8	G3/8	29	14,5	16,7	Ø21 *

Fittings Mod. 3033

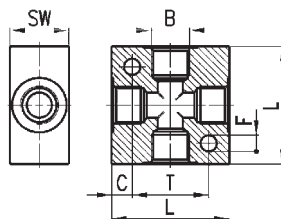

DIMENSIONS

Mod.	B	C	F	L	T	SW
3033 1/8	G1/8	4	4,5	25	17	16
3033 1/4	G1/4	7	5,5	40	26	20
3033 3/8	G3/8	8	5,5	50	34	26
3033 1/2	G1/2	8	5,5	50	34	32

Tubes Mod. PV...

Tubing (PVC reinforced)
blue.



DIMENSIONS

Mod.	D/d	Operating pressure at 20°C
PV 6/4	6/4	70 bar
PV 8/6	8/6	58 bar
PV 10/8	10/8	40 bar
PV 12/10	12/10	30 bar
PV 15/12,5	15/12,5	30 bar

Tubes Mod. TRN...

Tubing (Rilsan)
* on request

- Natural
- * Blue
- * Red
- * Green
- * Black
- * Yellow



DIMENSIONS

Mod.	D/d	Operating pressure at 20°C
TRN 4/2	4/2	30 bar
TRN 5/3	5/3	25 bar
TRN 6/4	6/4	20 bar
TRN 8/6	8/6	14 bar
TRN 10/8	10/8	11 bar
TRN 12/10	12/10	9 bar

Tubes Mod. TPE...

Tubing (Polyethylene)
Plain, blue



DIMENSIONS

Mod.	D/d	Operating pressure at 20°C
TPE 5/3	5/3	12 bar
TPE 6/4	6/4	11 bar
TPE 8/6	8/6	8 bar
TPE 10/8	10/8	7 bar

Tubes Mod. TSP..

Coil (Rilsan)

blue (other colours available on request).



DIMENSIONS

Mod.	D/d	max. working pressure at 20°	ø ext.	L. closed	L. max.
TSP 6/4	6/4	20 bar	50	820	15
TSP 8/6	8/6	14 bar	64	1000	15
TSP 10/8	10/8	11 bar	86	1000	15
TSP 12/10	12/10	9 bar	114	1050	15

Tubes clamp Mod. MPL...

Tube clamp

blue.



DIMENSIONS

Mod.	øTUBE	L	A	d	P
MPL 4	4/2	115	19	2,5	11,5
MPL 6	6/4	115	19	2,5	11,5
MPL 8	8/6	144	19	3,5	14,5
MPL 10	10/8	172	19	4,5	17,5

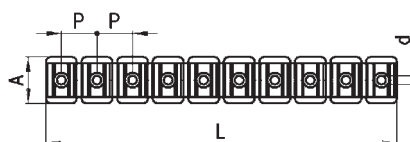

Tubes cutter Mod. PNZ...



Mod.

PNZ-12 (small tube cutter)

PNZ-25 (large tube cutter)